



Pollo Export Corp. +1(954)415-1625

Boca Raton-Florida 33486

LITTLE BEAVER HYDRAULIC POWER UNIT

Gas

- PS-18H - Hydraulic Power Source w/ 18 HP Honda w/ 3 wheel kit
- PS-20HA - Hydraulic Power Source w/ 20 HP Honda w/ 3 wheel kit
- S-24H - Hydraulic Power Source w/ 24 HP Honda w/ 3 wheel kit .

Diesel

- S-19D - Hydraulic Power Source w/ 19 HP Diesel w/ 3 wheel kit.



AUGER HANDLE ATTACHMENTS

- HDL-110 - One-man Handle Attachment w/ 200 rpm motor
- HDL-210 - Two-man Handle Attachment w/ 200 rpm motor
- HDL-3212 - Two-man Handle Attachment - 3000 psi - Hi Torque
(Above handles have 10' hose length w/one piece heavy duty torque tube)

Additional motor speeds available

- HYD-2MHNPT - 2 Man Hydraulic Handle w/150 rpm motor
(15 ft. hose length w/one piece heavy duty torque tube)

- 9093-A - Torque Tube Bracket
(required only if not using above handle attachments w/PS-18)

SNAP-ON AUGERS

- 1.5X36-SSS Auger 1.5" x 36"
- 2X36-SSS Auger 2" x 36"
- 3X36-SSS Auger 3" x 36"
- 4X36-SSS Auger 4" x 36"
- 5X36-SSS Auger 5" x 36"
- 6X36-SSS Auger 6" x 36"
- 7X36-SSS Auger 7" x 36"
- 8X36-SSS Auger 8" x 36"
- 9X36-SSS Auger 9" x 36"
- 10X36-SSS Auger 10" x 36"
- 12X36-SSS Auger 12" x 36"
- 14X36-SSS Auger 14" x 36"
- 16X36-SSS Auger(Nursery)

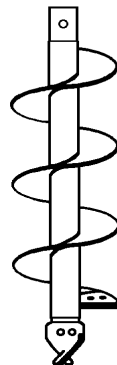

- 1.5X42-SSS Auger 1.5" x 42"
- 2X42-SSS Auger 2" x 42"
- 3X42-SSS Auger 3" x 42"
- 4X42-SSS Auger 4" x 42"
- 5X42-SSS Auger 5" x 42"
- 6X42-SSS Auger 6" x 42"
- 7X42-SSS Auger 7" x 42"
- 8X42-SSS Auger 8" x 42"
- 9X42-SSS Auger 9" x 42"
- 10X42-SSS Auger 10" x 42"
- 12X42-SSS Auger 12" x 42"
- 14X42-SSS Auger 14" x 42"

SNAP-ON EXTENSIONS

- 9054-3X36 Extension 3" x 36"
- 9054-4X36 Extension 4" x 36"
- 9054-5X36 Extension 5" x 36"
- 9054-6X36 Extension 6" x 36"
- 9054-7X36 Extension 7" x 36"
- 9054-8X36 Extension 8" x 36"



- 9054- 9X36 Extension 9" x 36"
- 054-10X36 Extension 10" x 36"
- 9054-12X36 Extension 12" x 36"
- 54-14X36 Extension 14" x 36"
- 9054-A Extension 18" Tube
- 9054 Extension 36" Tube

SUBJECT TO CHANGE WITHOUT NOTICE

PENGO STYLE AUGERS

6X36-SSP	Pengo Style Auger	6" x 36"
6X42-SSP	Pengo Style Auger	6" x 42"
7X36-SSP	Pengo Style Auger	7" x 36"
7X42-SSP	Pengo Style Auger	7" x 42"
8X36-SSP	Pengo Style Auger	8" x 36"
8X42-SSP	Pengo Style Auger	8" x 42"
9X36-SSP	Pengo Style Auger	9" x 36"
9X42-SSP	Pengo Style Auger	9" x 42"
10X36-SSP	Pengo Style Auger	10" x 36"
10X42-SSP	Pengo Style Auger	10" x 42"
12X36-SSP	Pengo Style Auger	12" x 36"
12X42-SSP	Pengo Style Auger	12" x 42"
14X36-SSP	Pengo Style Auger	14" x 36"
14X42-SSP	Pengo Style Auger	14" x 42"



PENGO STYLE POINTS & BLADES

9027-P	Pengo Style Point
9027-PC	Pengo Style Point (Carbide) Includes Mounting Bolts
9023-P35	Pengo Style Blade (Standard)
9023-P35CS	Case of 100 Blades
9023-P35HS	P.S. Blade (Hardsurfaced)
9023-P35CT	P.S. Blade (#35 Carbide)
9023-5T30	P.S. Blade (Chisel)
9023-5T30C	P.S. Blade (Chisel Carbide)
9023-P1336	P.S. Blade (Blunt Carbide) Includes Rubber Lock
9023-PR	Rubber Lock

Pengo Style point and blades are standard on all Pengo Style Augers.

BUCKET AUGERS

9067-4	Bucket Auger Only
9067-6	Bucket Auger Only
9067-8	Bucket Auger Only
9067-10	Bucket Auger Only
9067-12	Bucket Auger Only

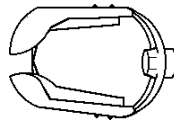

B-4	Bucket Auger Assembly
B-6	Bucket Auger Assembly
B-8	Bucket Auger Assembly
B-10	Bucket Auger Assembly
B-12	Bucket Auger Assembly

Includes 3' pipe and adaptor

9063

Drill Chuck with Adaptor

NET

REPLACEMENT POINTS & BLADES FOR SNAP-ON AUGERS

9027 Point11.95 (Fits 4", 5", 6", 7", 8", 9", 10" & 12" Augers.)

9027-16 Point24.00 (Fits 14" & 16" Augers only.)

9023-4	4" & 5" Blade
9023-6	6" & 7" Blade.
9023-8	8" Blade
9023-9	9" Blade
9023-10	10" Blade
9023-12	12" Blade
9023-14	14" Blade
9023-16	16" Blade

9027-S1.5	1.5" Screw-on Point
9027-S2	2" Screw-on Point
9027-S3	3" Screw-on Point

(Fits 1.5", 2" & 3" Snap-on Augers.)

CARBIDE BLADES FOR SNAP-ON AUGERS

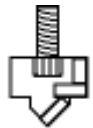

9023-C1.5	1.5" Carbide Blade
9023-C2	2" Carbide Blade
9023-C3	3" Carbide Blade
9023-C4	4" Carbide Blade
9023-C5	5" Carbide Blade
9023-C6	6" Carbide Blade

9023-C7	7" Carbide Blade
9023-C8	8" Carbide Blade
9023-C9	9" Carbide Blade
9023-C10	10" Carbide Blade
9023-C12	12" Carbide Blade
9023-C14	14" Carbide Blade

NOTE: 1-1/2", 2" & 3" Carbide Blades are Screw-on and fit the Snap-on augers only
4" thru 14" Carbide Blades include mounting bolts and lock nuts.